

This map is reproduced from or based upon Ordnance Survey material with the permission of Ordnance Survey on behalf of the Controller of Her Majesty's Stationery Office (c) Crown copyright. Unauthorised reproduction infringes Crown Copyright and may lead to prosecution or civil proceedings. London Borough of Harrow 100019206.

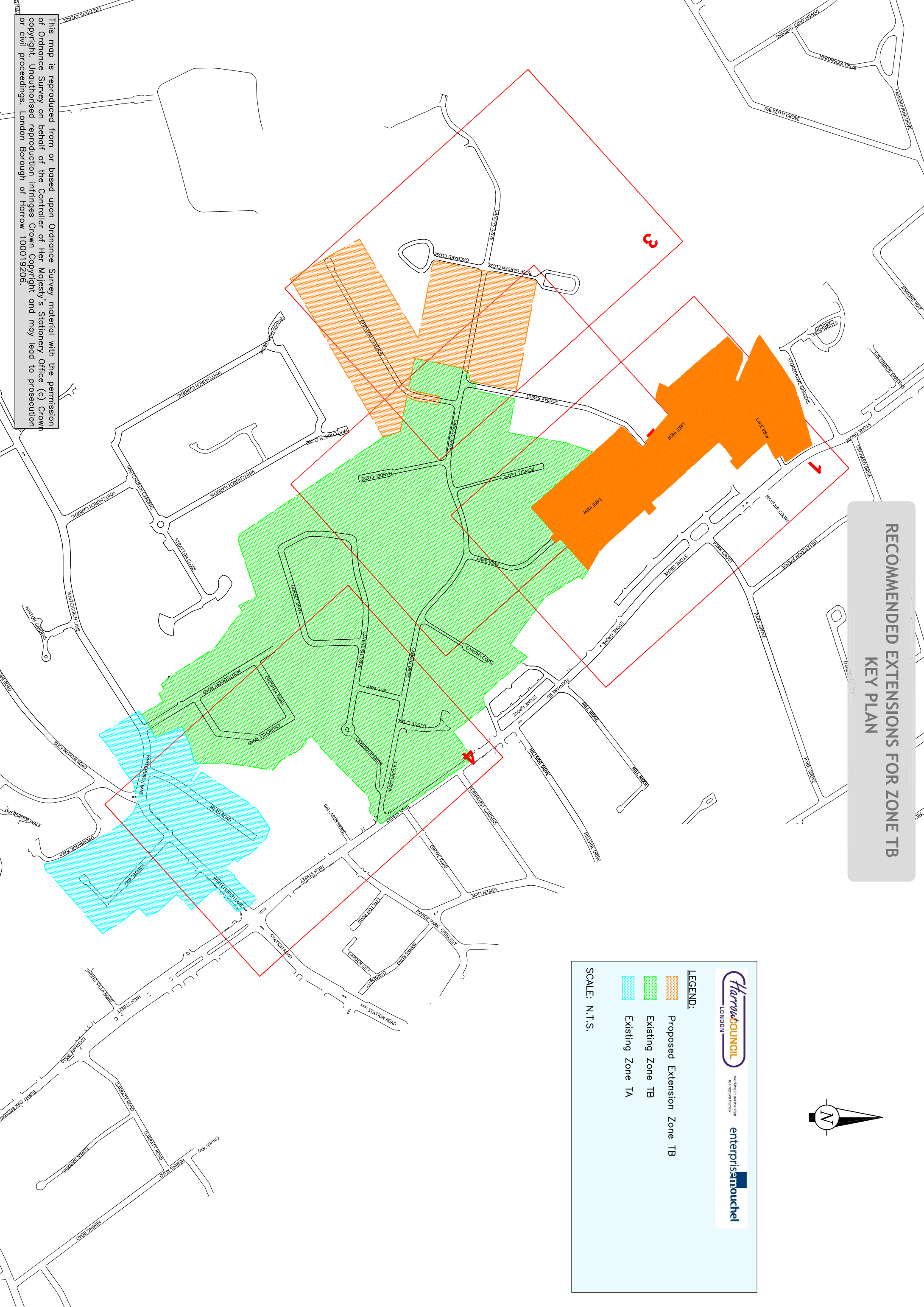

RECOMMENDED EXTENSIONS FOR ZONE TB
KEY PLAN

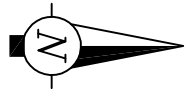

Harrow Council
LONDON

working in partnership
with the council

enterprissmouchel

LEGEND:

- Proposed Extension Zone TB
- Existing Zone TB
- Existing Zone TA

SCALE: N.T.S.

LEGEND:

- Proposed Extension Zone TB
- Existing Zone TB
- Existing Zone TA
- Proposed double yellow lines.
- Existing double yellow lines.
- Proposed single yellow lines
(Operational Monday to Friday
11 – 12 Middy)
- Existing single yellow line
- ▨ Proposed Resident Parking Bays
- ▨ Existing Resident Parking Bays
- ▨ Proposed Pay & Display Bays
- ▨ Existing Shared Pay & Display Bays
- ▨ Existing Pay & Display Bays

SCALE: N.T.S.

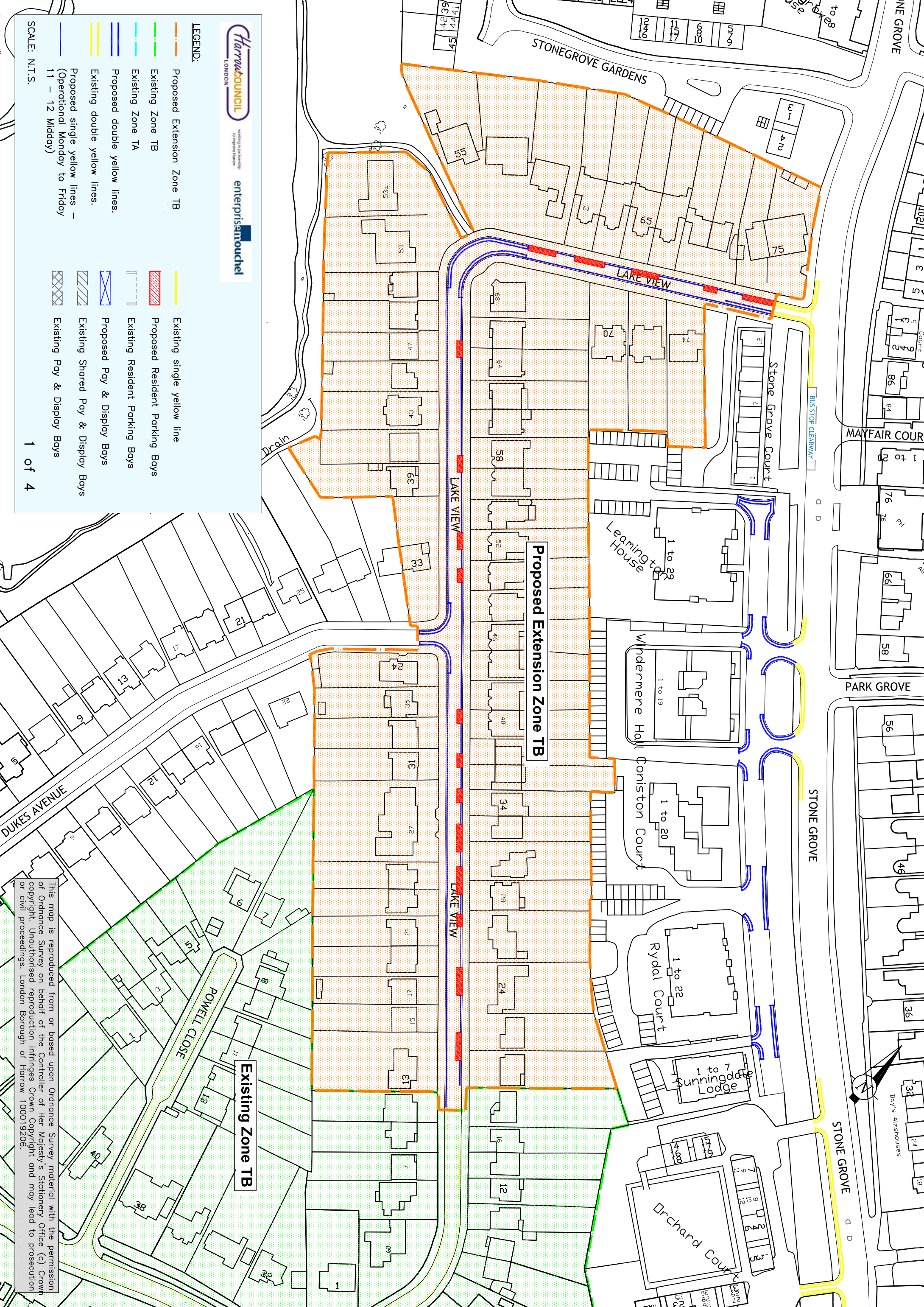

This map is reproduced from or based upon Ordnance Survey material with the permission of Ordnance Survey on behalf of the Controller of Her Majesty's Stationery Office (c) Crown copyright. Unauthorised reproduction infringes Crown Copyright and may lead to prosecution or civil proceedings. London Borough of Harrow 100019206.

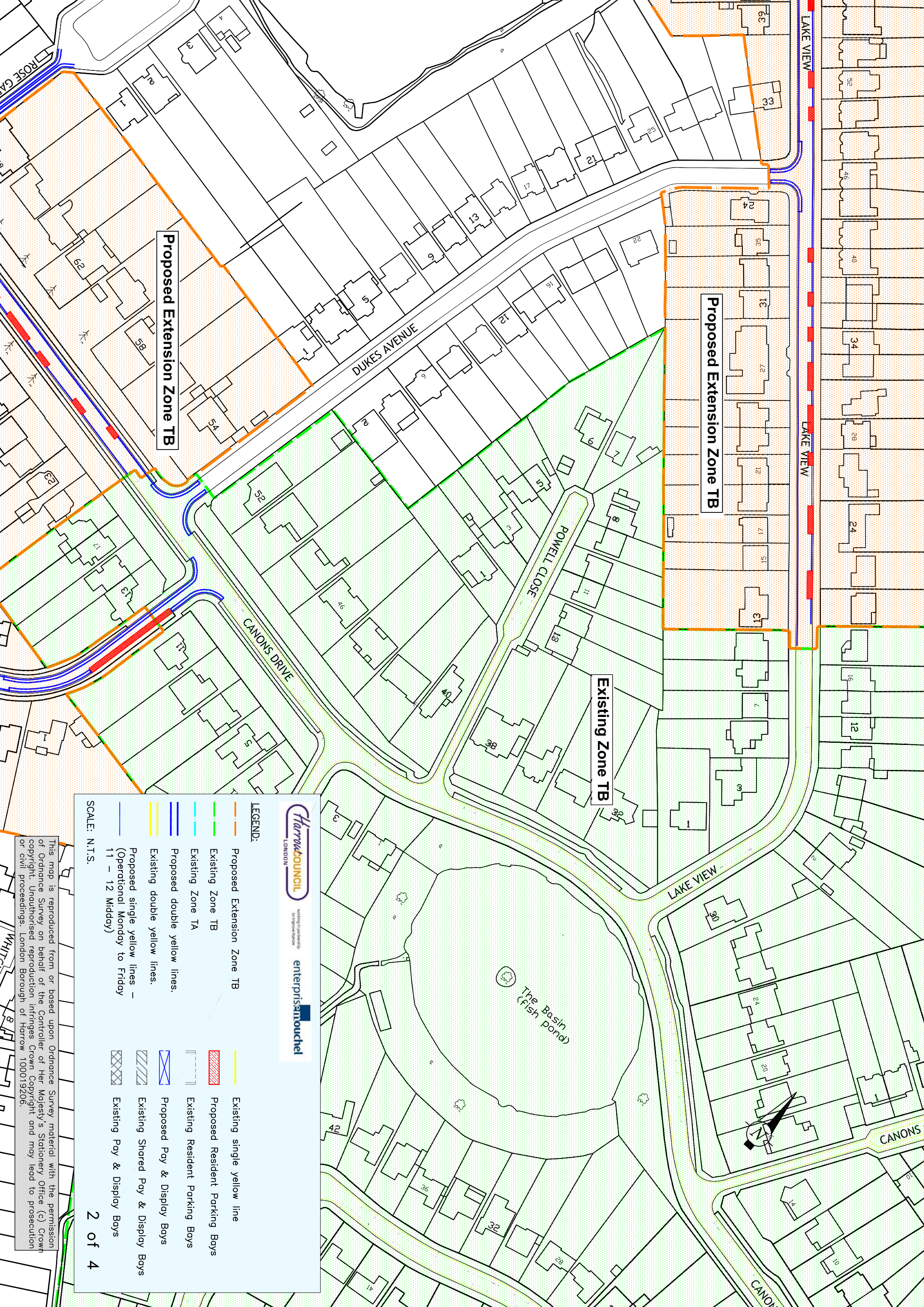













Proposed Extension Zone TB

Proposed Extension Zone TB

Existing Zone TB

LEGEND:

	Proposed Extension Zone TB		Existing single yellow line
	Existing Zone TB		Proposed Resident Parking Bays
	Existing Zone TA		Existing Resident Parking Bays
	Proposed double yellow lines.		Proposed Pay & Display Bays
	Existing double yellow lines.		Existing Shared Pay & Display Bays
	Proposed single yellow lines – (Operational Monday to Friday 11 – 12 Midday)		Existing Pay & Display Bays

SCALE: N.T.S.



This map is reproduced from or based upon Ordnance Survey material with the permission of Ordnance Survey on behalf of the Controller of Her Majesty's Stationery Office (c) Crown copyright. Unauthorised reproduction infringes Crown Copyright and may lead to prosecution or civil proceedings. London Borough of Harrow 100019206.

This map is reproduced from or based upon Ordnance Survey material with the permission of Ordnance Survey on behalf of the Controller of Her Majesty's Stationery Office (c) Crown copyright. Unauthorised reproduction infringes Crown Copyright and may lead to prosecution or civil proceedings. London Borough of Harrow 100019206.

LEGEND:

- Proposed Extension Zone TB
- Existing Zone TB
- Existing Zone TA
- Proposed double yellow lines.
- Existing double yellow lines.
- Proposed single yellow lines – (Operational Monday to Friday 11 – 12 Midday)
- Existing single yellow line
- ▨ Proposed Resident Parking Bays
- ▨ Existing Resident Parking Bays
- ▨ Proposed Pay & Display Bays
- ▨ Existing Shared Pay & Display Bays
- ▨ Existing Pay & Display Bays

SCALE: N.T.S. **3 of 4**

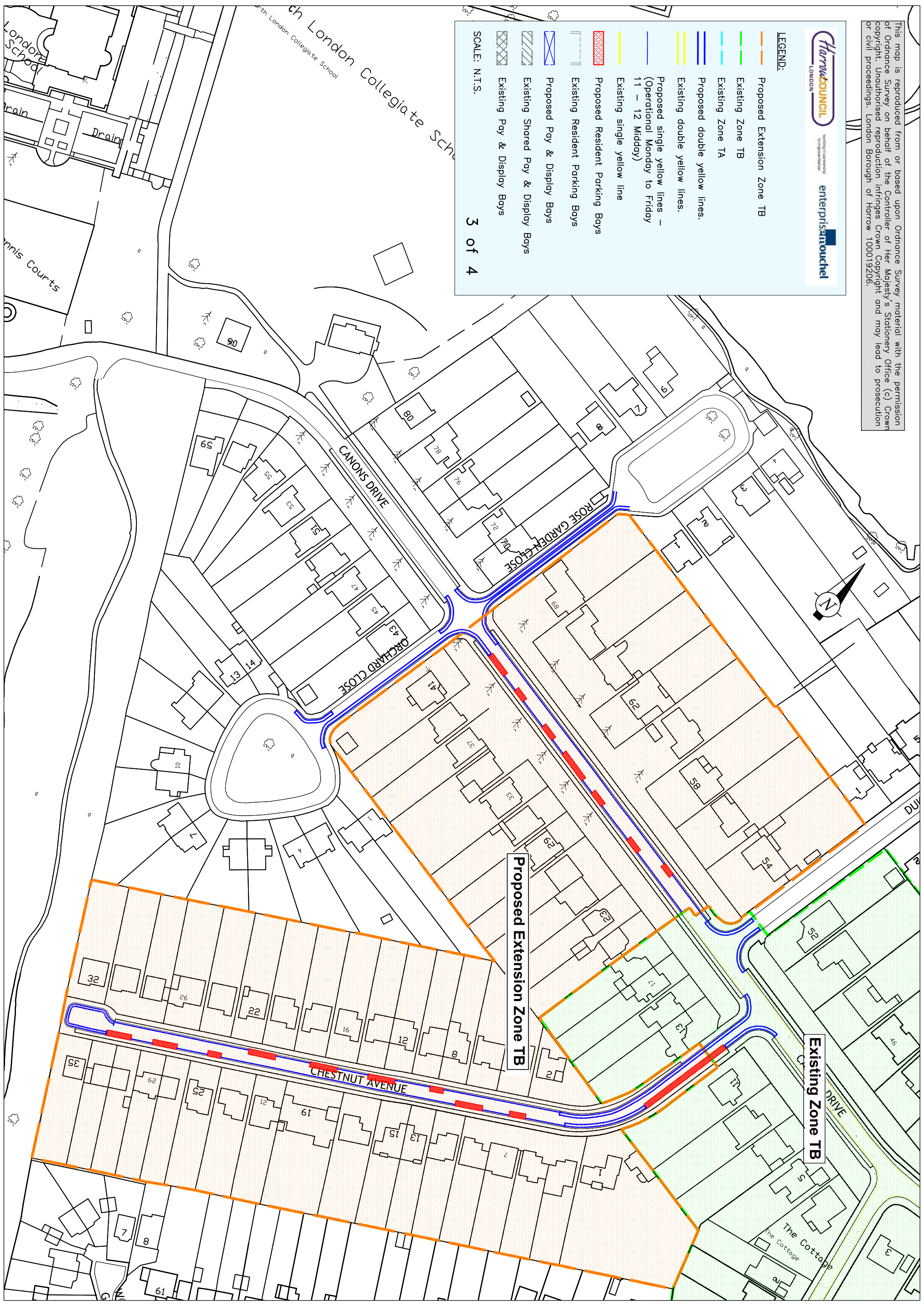

Proposed Extension Zone TB

Existing Zone TB

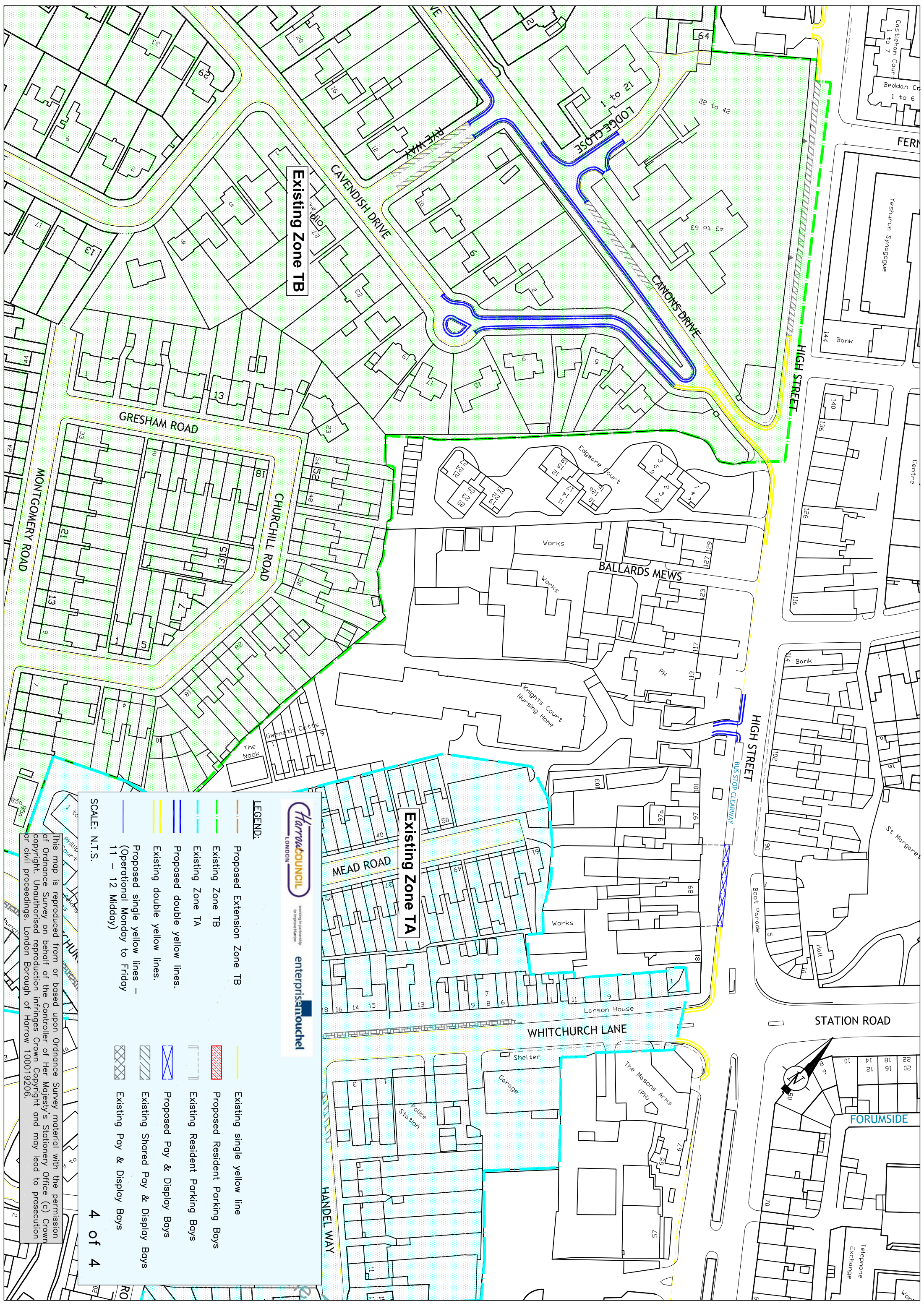

Existing Zone TB

Existing Zone TA

Harrow Council
LONDON

Working in partnership to improve Harrow

enterprisemouchel

LEGEND:

- Proposed Extension Zone TB
- Existing Zone TB
- Existing Zone TA
- Proposed double yellow lines.
- Existing double yellow lines.
- Proposed single yellow lines – (Operational Monday to Friday 11 – 12 Midday)
- Existing single yellow line
- ▨ Proposed Resident Parking Boys
- ▨ Existing Resident Parking Boys
- ▨ Proposed Pay & Display Bays
- ▨ Existing Shared Pay & Display Bays
- ▨ Existing Pay & Display Bays

SCALE: N.T.S.

4 of 4

This map is reproduced from or based upon Ordnance Survey material with the permission of Ordnance Survey on behalf of the Controller of Her Majesty's Stationery Office (c) Crown Copyright. Unauthorised reproduction infringes Crown Copyright and may lead to prosecution or civil proceedings. London Borough of Harrow 100019206.